

ROCKINGER Zuggabel GNZ / ROCKINGER drawbars GNZ

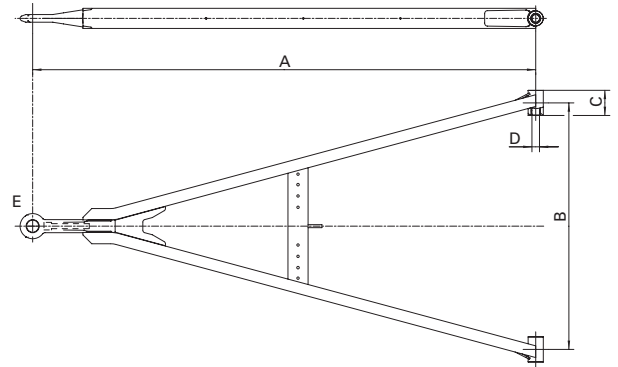

Auswahltabelle / Selection table

Typ / Type	R / perm. total weight (t)	D (kN)	Abmessung / Dimension A (mm)	Abmessung / Dimension B (mm)	Abmessung / Dimension C (mm)	Abmessung / Dimension D (mm)	UN-Profil / UN profile	E
GNZ 9.4	9,4	71,0	650–1950	320–1250	50–100	20–50	U 50	1, 2
GNZ 18	18,0	98,0	1000–2600	300–1400	60–100	24–50	U 65	1, 2, 3, 4, C
GNZ 27	27,0	125,0	1000–3100	200–1400	60–100	24–50	U 80	1, 2, 3, 4, C
GNZ 40	40,0	125,0/168,0	1000–3800	200–1500	70–100	24–50	U 100	1, 2, 3, 4, C
GNZ 50	50,0	190,0	1200–3800	600–1400	70–100	24–50	U 100	2, 3

Beispiel / example, Artikel-Nr. / part no.: **YD 210 130 50 1 0 0**
 Stelle / place: 1–2 Typ/Type 3–5 (Länge/length) | 6–8 (Breite/width) | 9+10 Auge/Eye 11 Zugöse/drawbar eye 12 13

YA = GNZ 9,4
 YD = GNZ 18
 YG = GNZ 27
 YF = GNZ 40
 YB = GNZ 50

10 = 60/24	03 = 100/28
20 = 80/26	04 = 100/32
30 = 70/26	05 = 70/40
40 = 80/25	06 = 90/40
50 = 80/28	07 = 100/40
60 = 80/30	08 = 90/50
70 = 100/30	09 = 80/30*
80 = 100/35	weitere Ausführungen auf Anfrage
90 = 100/30*	other versions on demand
00 = 60/20	
01 = 70/24	
02 = 60/25	* = Silentblock

1 = 40 DIN 74054 A
 2 = 50 DIN 74053 A
 3 = 50 Schwerlast/heavy duty
 4 = Schweizer Zugöse
 Swiss drawbar eye
 C = Zuggfanne KS*80
 Hitch head KS*80

Weitere Zuggabeln auf Anfrage
 Other forked drawbars on demand